



INSTALLATION GUIDE & USER MANUAL AFL/PIR/BK



ENSURE POWER SUPPLY IS OFF WHEN HANDLING ANY ELECTRICAL EQUIPMENT.

- This product may need to be installed by a qualified electrical installer.
- Please read this guide in its entirety to fully understand the products before attempting any install.
- All electrical work should be completed in accordance with the latest IET regulations, and/or any other relevant rules, regulations or laws of the country in which it is being installed.
- The item must be installed in isolation from any insulating material and be adequately ventilated to prevent premature failure.
- Ensure power supply is isolated prior to installation, maintenance or performing any other form of electrical work.
- In the event of incorrect or improper function with specific regard to any of ALL LED's products and contact ALL LED for further advice.

Technical Specifications

Product Code	AFL/PIR/BK
Operating Voltage	220 - 240V AC
Max Output Power	100W
Output Current (Max)	0.43A
No Load Power (W)	<0.5
Class	II
Body Material	ABS
Frame Colour	Carbon Black
Ingress Protection	IP65
Ambient Operating Temperature (°C)	-20°C ~ +40°C
Input Frequency (Hz)	50/60Hz
Guarantee	3 Years
Detection Angle	120°
Ambient Light (Lux)	10-2000
Time Range	10 Seconds - 7 Min
Detection Range	2m - 10m

Dimensions (mm)

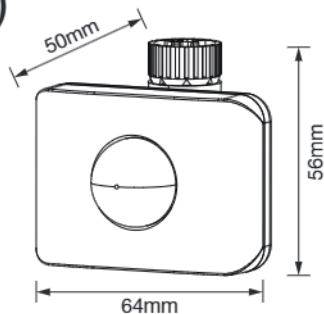

Installation Instructions

1. Unscrew the cap

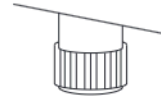

2. Pull out the contact pin

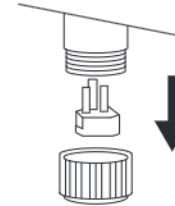

3. Plug in the sensor by lining up the pins and screw on

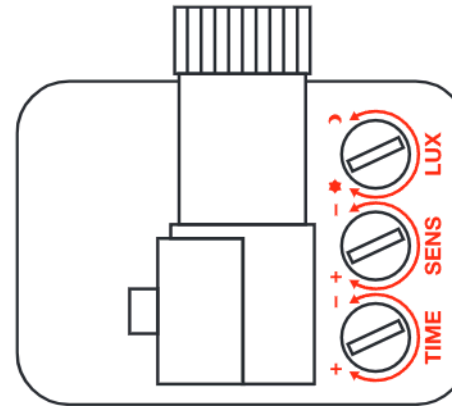
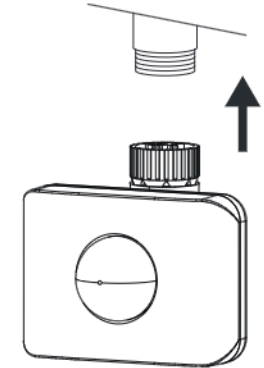

- **Ambient Light (LUX)**
LUX is the setting for the ambient light level below which the PIR detector will be activated
- **Sensitivity**
Changes how easily the sensor can detect movement
- **Timer**
Changes how long the light remains on

The approximate common position for the sensor to activate the luminaire during twilight conditions is as per the diagram.

We suggest the starting position for adjusting the sensor parameters should be as per the diagram

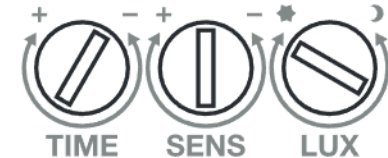

Testing:

1. Turn the SENS knob fully clockwise to the maximum setting.
2. Turn the TIME knob fully counterclockwise to the minimum setting.
3. Turn the LUX knob fully clockwise to the maximum (SUN) setting.

When you switch on the power, the controlled load will not immediately activate. After a 30-second preheat period, the load will turn on when the sensor detects motion. Once the load turns off, it will turn on again if the sensor detects motion within 5 to 15 seconds.

After the initial activation, allow 5 to 10 seconds before triggering the sensor again. The load should activate upon detection. If the sensor does not detect any motion, the load will remain off.

To test the load in low light conditions:

Turn the LUX knob fully counterclockwise to the minimum setting.

If the LUX setting is below 3 LUX (dark), the load and sensor should not activate in daylight. Cover the detection window with an opaque object (e.g., a towel) to simulate darkness, and the load will activate.

Without motion detection, the load will turn off within 5 to 15 seconds.

Note: When testing in daylight, ensure the LUX knob is set to the (SUN) position; otherwise, the luminaire will not function properly.

MANUAL OVERRIDE FUNCTION:

- How to activate override mode: When the sensor is in automatic sensor mode and the light is ON, turn the wall switch OFF-ON-OFF-ON within 3 seconds, and the sensor will be in override mode - the light will remain on.
- A solid red LED behind detection window shows when override is active.
- How to return to automatic sensor mode: Switch off the wall switch, wait 10 seconds and then switch it back on, then the sensor will be back in automatic sensor mode.

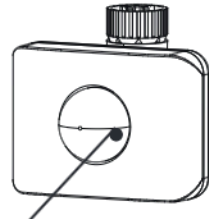

Manual override indicator

Troubleshooting Guide

The load does not work:

- Check if the wiring connections for power and load are correct.
- Verify that the load is functioning properly.
- Ensure the working light setting matches the ambient light conditions.

The sensitivity is poor:

- Check if there is an obstruction in front of the detection window that may affect signal reception.
- Ensure the ambient temperature is not too high.
- Confirm that the induction signal source is within the detection field.
- Verify that the installation height matches the height specified in the instructions.
- Make sure the movement direction is correct.

The sensor cannot shut off the load automatically:

- Check if there is a continuous signal in the detection field.
- Verify that the time delay is not set to the longest duration.
- Ensure the power supply matches the specifications in the instructions.
- Check if there are significant temperature changes near the sensor, such as from air conditioning or central heating.



ATTENTION

IF ANY PROBLEMS PERSIST, PLEASE CALL THE ALL LED TECHNICAL DEPARTMENT FOR FURTHER ASSISTANCE.

Safety

- Do not cover the ground contact.
- Do not cover the luminaire, hang or fasten anything from it.
- Do not operate if any visible damage can be seen to the product.
- Do not operate if any water ingress has occurred.
- Do not operate if any smoke, steam or crackling noises can be heard from the luminaire.
- Do not operate if any signs of overheating are recognised.
- Avoid installation in any areas where there is a risk of strong mechanical loads.
- Do not place any material over the lens or LED diode/chip.
- Do not insert objects into the luminaire.
- Do not clean using any solvent based abrasive or aggressive product.
- Do not pull any cables connected to the product.
- Do not direct the luminaire into a person's eyes, as this unit may have an intense light output, which if incorrectly used may cause eye damage.
- Light engines/LEDs and other light sources may heat up, please take care when handling the products.
- The manufacturer will not be deemed liable or held responsible for any damages caused by faults or manufacturing defects that may be present in any of its products or the misuse or incorrect installation of this device. Please refer to our troubleshooting guide for further information.
- The manufacturer will not be held liable for any death(s) or injuries caused by misuse or poor installation or any unreported faults of this product version or versions thereof.
- LEDs are sensitive to electrostatic discharge. Do not touch the surface of the LED module.
- Do not connect to a temporary electricity supply, this may damage the electronics.
- Light fittings with an integrated emergency option come with a separate installation and wiring leaflet. Please refer to this manual for further details. If the manual is unavailable please contact an ALL LED representative for assistance.
- It is strongly recommended that a Residual-Current Device (RCD) is used with this product to minimise the risk of electrocution.
- REPLACE DAMAGED GLASS IMMEDIATELY.
- Keep away from children.
- Do not install in areas with; high acid rain, acidic soil, high salt content, coastal environments, high concentration of chemical substances.

Returns & Faulty Items

- If any problem is encountered during or after installation, please call ALL LED technical department to get the problem resolved as soon as possible.
- Please do not just return the item to the outlet you purchased it from, as you are only entitled to a replacement or refund after the unit has undergone testing and the unit has been confirmed as having a manufacturing defect/fault. Your statutory rights are not affected.
- The manufacturer will not be deemed liable or held responsible for any damages caused by faults or manufacturing defects that may be present in any of its products or the misuse or incorrect installation of this device.
- All installations must be carried out in accordance with this installation guide and user manual.
- All goods are supplied under the terms and conditions of ALL LED LTD, a copy of which may be obtained upon written request.



Environmental Protection
Waste electrical products should not be disposed of with household waste. Please recycle where facilities exist. Check with your Local Authority or retailer for recycling advice



ISOLATE MAINS SUPPLY BEFORE HANDLING ANY ELECTRICAL PRODUCTS



The manufacturer will not be deemed liable or held responsible for any damages caused by faults or manufacturing defects that may be present in any of its products or the misuse or incorrect installation of this device. Your statutory rights are not affected.



ALL LED LTD
42 Sedgwick Road,
Luton, LU4 9DT

www.allledgroup.com
sales@allledgroup.com
Tel: +44 (0)208 841 9000